

Corporate Headquarters:

167 Rowland Drive
Johnson City, TN 37601
Toll Free U.S.: 866-4-Alemite
Toll Free Canada: 800-267-8022
International: 803-802-0001
Fax U.S.: 800-648-3917
Fax Canada: 800-267-2880
Fax International: 803-802-0192

LIT196

www.alemite.com

**OIL-MIST
LUBRICATION
SYSTEMS
CATALOG**

www.alemite.com



OIL-MIST LUBRICATION SYSTEMS

TABLE OF CONTENTS

Introduction to Oil Mist	2
3920 Series generators	4
3940 Series generators	5
M Series generators.....	6
High capacity generators.....	8
System components.....	10
System accessories.....	17
Technical data.....	20
Mist nozzle performance curves.....	20
Mist nozzle performance curves for large capacity generators with Thermo-Aire air heaters	22
Dimensions	24
Typical installations.....	27
Carbon Shield systems.....	29
Index.....	30



OIL-MIST LUBRICATION SYSTEMS

INTRODUCTION TO OIL-MIST

Oil-Mist is a centralized lubrication system that continuously and efficiently atomizes oil into small, non-flammable particles and then conveys and delivers the correct amount of the pressurized lubricant to the surfaces requiring lubrication. Oil mist is the only lubrication system that can be used to continuously lubricate several different classes of operating or stand-by equipment in widely dispersed physical locations within the same facility using only one type of lubricant. Oil Mist is cost-justified, environmentally responsible and safe.

WHAT OIL-MIST CAN DO FOR YOU

Alemite Oil-Mist Lubrication Systems deliver *controlled, continuous* lubrication to bearings, gears, chains and other moving parts that are vital to the service life and productivity of plants and machinery. Alemite oil mist systems have been in operation for over 50 years. These systems are reliable, safe, responsible and, with no moving parts, require minimum maintenance.

HOW IT WORKS

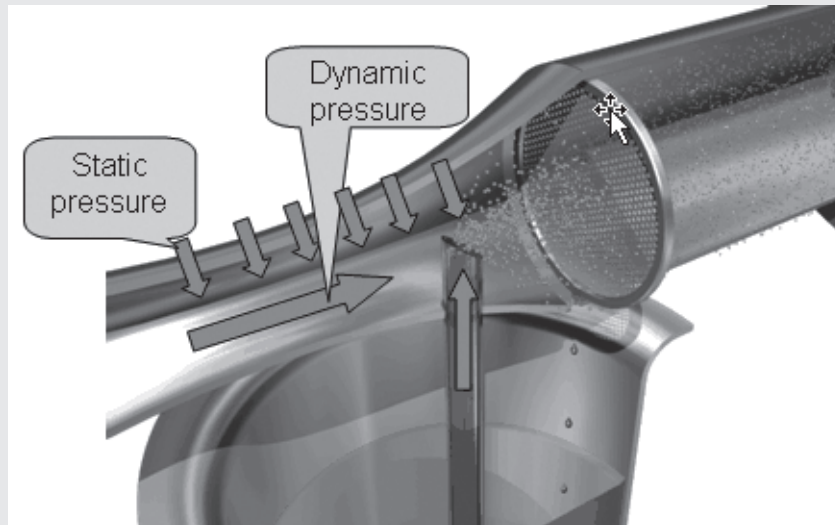

As compressed dry air passes through a venturi at very high speed, oil is introduced into the air stream by siphoning it from a reservoir. The resulting atomized oil particles average 1-5 microns.

The suspended oil particles in the air resemble smoke and are dry enough to be transported at low pressure and velocity to distant machine elements.

Reclassifiers are used to introduce turbulence into the dry mist flow, causing the oil particles to coalesce and produce larger droplets which wet the interacting surfaces.



OIL-MIST LUBRICATION SYSTEMS

THERE ARE 2 METHODS OF APPLYING OIL-MIST TO MACHINE ELEMENTS:

PURE MIST

This method provides both primary lubrication and, when used in enclosed housings, a slight pressurization ($3/4$ to 2 psi) to prevent the entrance of damaging contaminants. The sump oil is emptied and the oil-mist “wets out” on the wearing surfaces to provide the lubricant film required to reduce friction and wear. By venting the used mist to the atmosphere, a flow of fresh, clean mist is constantly being introduced to lubricate and cool the wear surfaces. Unused condensed oil in the housing is constantly drained to a collection container for disposal.

PURGE MIST

Sump oil is retained and remains the primary form of lubrication and oil-mist simply supplies the slight pressurization of the housing to prevent the entrance of damaging contaminants. Existing oil life is greatly extended, reducing maintenance and lubricant replacement costs.

APPLICATIONS

Alemite has developed a broad line of equipment and application techniques to lubricate various machine elements from tiny, ultra-high speed parts for dentists’ drills to huge gears and bearings of steel rolling mills. Oil mist is particularly suitable to lubricate anti-friction bearings in virtually all categories of rotating machinery as well as chains, slides, ways, gears and practically any surface needing lubrication.

ADAPTABILITY

The number of machines utilizing oil-mist can be easily added to or reduced, usually with just a simple adjustment of the regulated air pressure.

SUITABILITY

Properly designed oil-mist systems:

- Meet all OSHA requirements for personnel safety
- Generated and transported mist is non-flammable
- Mist is not a carcinogen
- EPA does not regulate oil-mist
- Stray mist collection systems minimize housekeeping issues

BENEFITS

- Extended service life
- Reduced maintenance
- Reduced downtime
- Reduced lubricant use
- Reduced bearing temperatures



OIL-MIST LUBRICATION SYSTEMS

3920 SERIES OIL-MIST GENERATORS

Provides lubrication for multiple lubrication points

1. Relief valve

Provides over-pressure protection

2. Clear 1-pint nylon reservoir

Allows visual inspection of oil-level & mist generation

3. Refill loader fitting

Assures contamination-free oil replenishment

Requires manual refill pump
P/N 388034 (see page 16)

4. Aluminum mist head

Provides corrosion protection for long trouble-free service

5. Oil pick-up screen

Prevents entrance of contaminants into mist generator

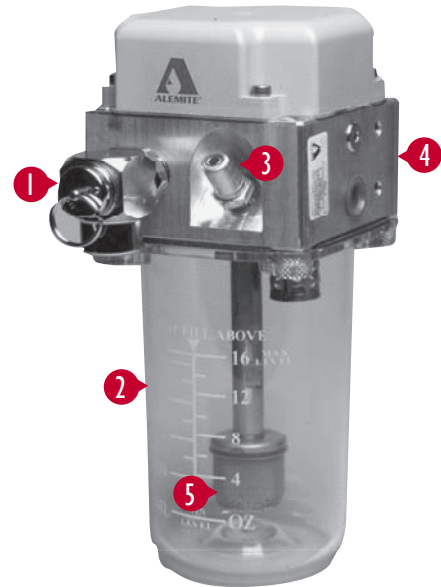

1. Float switch

Provides signal when oil replenishment is required

2. Filter/regulator

Adjusts mist generator performance; includes automatic water drain

3. Air solenoid valve

Allows automatic on-off operation when wired to machine driver or control

4. Steel mounting plate

Pre-piped assembly allows quick installation

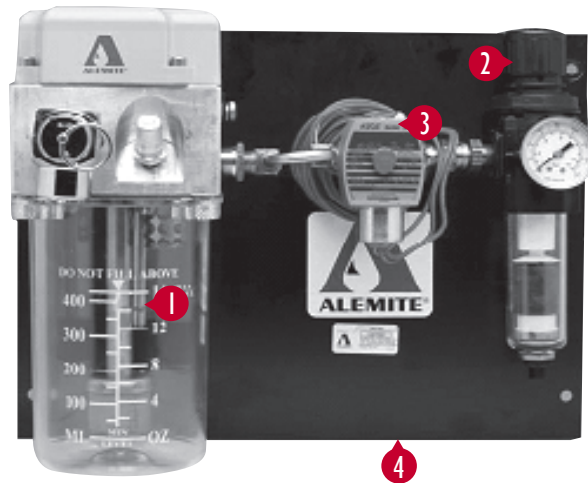

CFM nominal	Flow range	Product #	Mounting plate	Oil heater	Oil level switch	Filter/regulator	Air solenoid value
1	0.3 - 1.4 CFM	3922-A	-	-	-	-	-
		3922-AC	Yes	-	-	Yes	120 VAC
		3922-B	-	-	120 VAC	-	-
		3922-BC	Yes	-	120 VAC	Yes	120 VAC
		3922-BD	Yes	-	220 VAC	Yes	220 VAC

Approximate oil consumption rate = 0.277 x CFM = ounces per hour of operation



OIL-MIST LUBRICATION SYSTEMS

3940 SERIES OIL-MIST GENERATORS

Provides lubrication for multiple lubrication points or machines

1. Relief value

Provides over-pressure protection

2. Refill loader fitting

Assures contamination-free oil replenishment
Requires manual refill pump P/N 388034 (see page 16)

3. Oil level sight glass

Provides visual inspection of oil level

4. Cast aluminum 1-gallon reservoir

Baked polyester powder coated for decades of corrosion protection

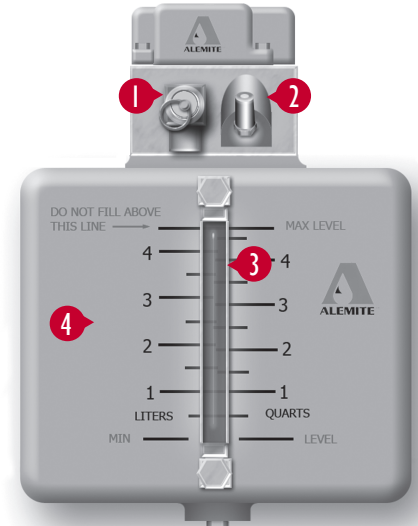

1. Float switch (inside the reservoir)

Provides signal when oil replenishment is required

2. Filter/regulator

Adjusts mist generator performance; includes automatic water drain

3. Air solenoid valve

Allows automatic on-off operation when wired to machine driver or control

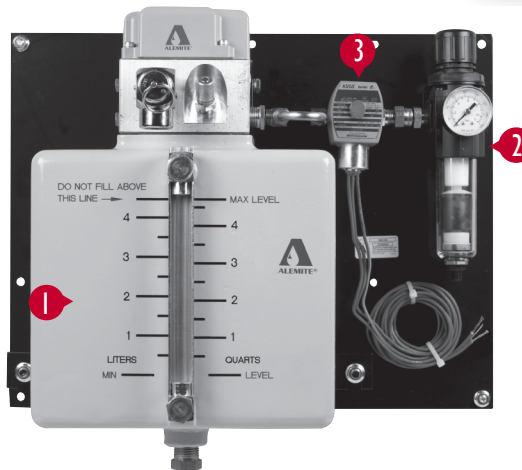

CFM nominal	Flow range	Product #	Mounting plate	Oil heater	Oil level switch	Filter/regulator	Air solenoid valve
1	0.3 - 1.4 CFM	3942-BC	Yes	-	120 V AC	Yes	120 V AC
		3942-BD	Yes	-	220 V AC	Yes	220 V AC
		3942-CB	Yes	120 V AC	120 V AC	Yes	-
		3942-CC	Yes	120 V AC	120 V AC	Yes	120 V AC
		3942-DD	Yes	120 V AC	220 V AC	Yes	220 V AC
2.3	0.8 - 3.1 CFM	3943-B	-	-	120 V AC	-	-
		3943-BC	Yes	-	120 V AC	Yes	120 V AC
		3943-BD	Yes	-	220 V AC	Yes	220 V AC
		3943-CB	Yes	120 V AC	120 V AC	Yes	-
		3943-CC	Yes	120 V AC	120 V AC	Yes	120 V AC
		3943-DD	Yes	120 V AC	220 V AC	Yes	220 V AC

Approximate oil consumption rate = 0.277 x CFM = ounces per hour of operation



OIL-MIST LUBRICATION SYSTEMS

MODULAR OIL-MIST LUBRICATION GENERATORS

1. Signal devices (optional)

- Horn
- Alarm
- Refill operation
- Normal

2. Air temperature digital display (optional)

3. 3 gallon (usable) oil reservoir

4. Control box with switches (optional)

5. Manual oil fill loader fitting

6. Pressure relief valve

7. Air heater (optional)

8. Oil level sight glass

9. Oil temperature gauge

10. Air regulator with gauge

11. Air filter with auto water drain

12. Internal oil heater

13. Internal float switches

14. Auto-refill oil solenoid valve (optional)

15. Mist pressure gauge

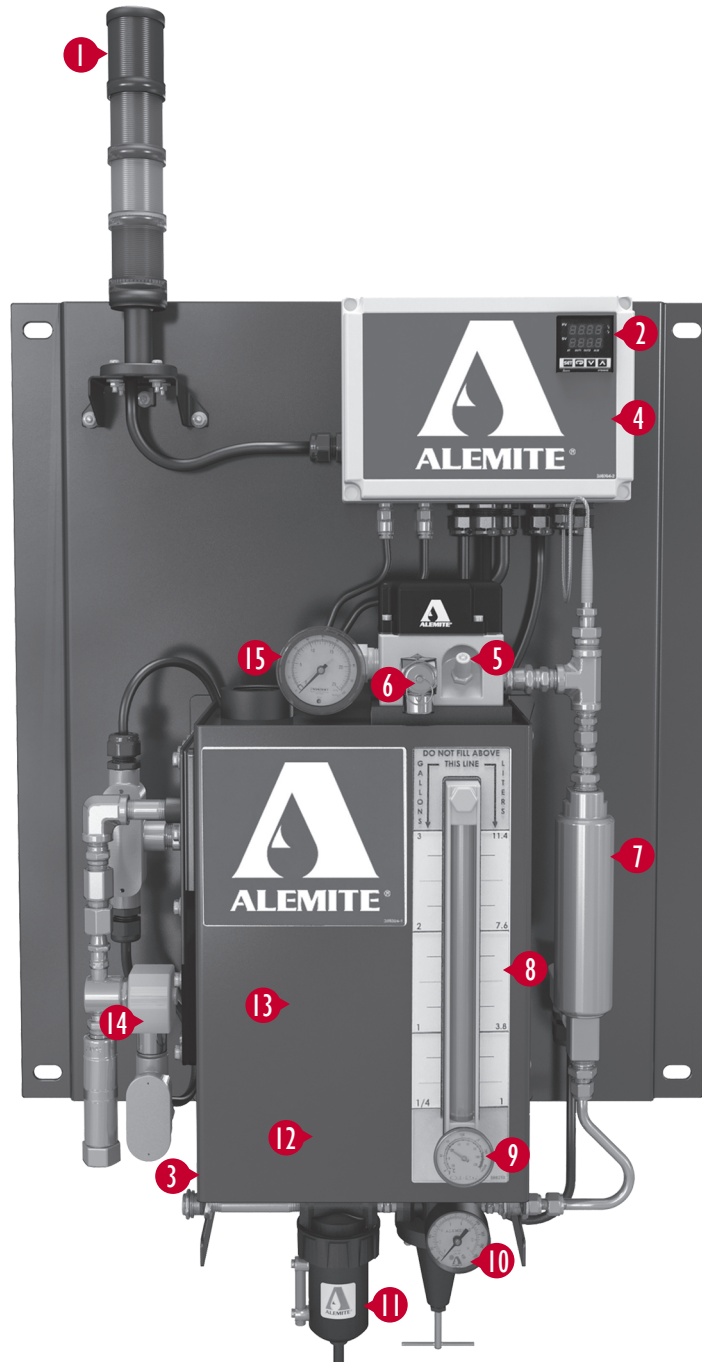



OIL-MIST LUBRICATION SYSTEMS

MODULAR OIL-MIST LUBRICATION GENERATORS

Product # description	Versions				
	A	B	C	D	E
Basic mist generator with 3-gallon reservoir with clean-out/inspection plate, relief valve, manual oil loader valve, mist pressure gauge, inlet air assembly (filter with auto water drain, regulator and pressure gauge) and oil heater (order manual refill pump P/N 388034 separately if indicated) *	✓	✓	✓	✓	✓
Mounting plate		✓	✓	✓	✓
Audible and visual alarm lights		✓	✓	✓	✓
High/low mist pressure switches		✓	✓	✓	✓
NEMA 4 control box		✓	✓	✓	✓
Automatic oil refill capability with solenoid valve, filter and switch (does not include pneumatic refill pump) **			✓	✓	
Air heater and temperature controller				✓	✓
Manual refill pump P/N 388034 required?	Yes	Yes	No	No	Yes

* A manual pump (P/N 388034) is required to refill oil reservoir. Sold separately.

** Includes 40-micron cleanable oil filter

Approximate oil consumption rate = 0.277 x CFM = ounces per hour of operation

Order number configurator

3 -

Product series

Voltage
 115 = 115 V AC 230 = 230 V AC

CFM
 1 = 1 CFM 4 = 4.3 CFM
 2 = 2.3 CFM 9 = 9.7 CFM

Version
 See table above

Optional automatic refill pump package (P/N 388415)

Includes 1:1 ratio air-driven pump with accessories including filter/regulator, 7' long hose and valves designed for use with 55-gallon oil drums.

Example: P/N 31159-A

Basic generator with 9.7 CFM nozzle, oil heater and mist pressure gauge only. 115 V AC supplied power.

Example: P/N 32304-B

Basic generator with 4.3 CFM nozzle, oil heater, mist pressure gauge, mounting plate, mist pressure switches, alarm lights and NEMA 4 control box. 230 V AC supplied power.

Example: P/N 31152-C

Basic generator with 2.3 CFM nozzle, oil heater, mist pressure gauge, mounting plate, mist pressure switches alarm lights and NEMA 4 control box, automatic oil refill capability. 115 V AC supplied power.



OIL-MIST LUBRICATION SYSTEMS

HIGH CAPACITY OIL-MIST GENERATORS

3.6-gallon oil reservoir

All units feature:

- Low oil level float switch
- Mist pressure switch (high & low)
- Oil level sight glass
- Air pressure gauge
- Mist pressure gauge
- Oil temperature gauge

Optional alarm annunciator

P/N 387275 is required to provide visual/audible alarm signals.

Optional automatic oil refill kit P/N

387789 includes 3-float float switch and in-line oil filter. Refill kit also requires oil solenoid valve P/N 383647-1 (115 V) or P/N 383647 (230 V).

Optional automatic refill pump

package P/N 388415 includes 1:1 ratio air-driven pump with accessories including filter/regulator, 7' long hose and valves designed for use with 55-gallon oil drums.



Product #	CFM nominal	Flow range	No. of nozzles	Mist outlet	Voltage
3725-A6	9.7	3.5 - 16.5 CFM	1	2 1/2" NPTF(f)	120 V AC 60/50 HZ
3720-A6	13	5.2 - 21 CFM			
3721-A6	21	7.5 - 33 CFM			
3722-A6	41	15 - 45 CFM	2	3" NPTF(f)	
3726-A6	65	31 - 73 CFM			
3720-B6	13	5.2 - 21 CFM	1	2 1/2" NPTF(f)	
3721-B6	21	7.5 - 33 CFM			
3722-B6	41	15 - 45 CFM	2	3" NPTF(f)	
3726-B6	65	31 - 73 CFM			

Approximate oil consumption rate = 0.277 x CFM = ounces per hour of operation



OIL-MIST LUBRICATION SYSTEMS

HIGH CAPACITY OIL-MIST GENERATORS

with Thermo-Aire® air heater and 3.6-gallon oil reservoir

All units feature:

- Low oil level float switch
- Mist pressure switch (high & low)
- Oil level sight glass
- Air pressure gauge
- Mist pressure gauge
- Oil temperature gauge
- Air temperature gauge

Optional alarm annunciator

P/N 387275 is required to provide visual/audible alarm signals.

Optional automatic oil refill kit P/N

387789 includes 3-float float switch and in-line oil filter. Refill kit also requires oil solenoid valve P/N 383647-1 (115V) or P/N 383647 (230V).

Optional automatic refill pump

package P/N 388415 includes 1:1 ratio air-driven pump with accessories including filter/regulator, 7' long hose and valves designed for use with 55-gallon oil drums.



Product #	CFM nominal	Flow range	No. of nozzles	Mist outlet	Voltage solenoid and oil heater	Voltage air heater
3730-RW6	13	5.2 - 21	1	2 1/2" NPTF(f)	120 V AC 60/50 Hz	240 V AC 60/50 Hz
3731-RW6	21	7.5 - 33				
3732-RW6	41	15 - 45	2	3" NPTF(f)		
3736-RW6	65	31 - 73				
3730-BW6	13	5.2 - 21	1	2 1/2" NPTF(f)	240 V AC 60/50 Hz	
3731-BW6	21	7.5 - 33				
3732-BW6	41	15 - 45	2	3" NPTF(f)		
3736-BW6	65	31 - 73				

Approximate oil consumption rate = 0.277 x CFM = ounces per hour of operation



OIL-MIST LUBRICATION SYSTEMS

OIL-MIST SYSTEM COMPONENTS

Application Reclassifier Fittings

Reclassifier fittings perform two critical functions:

1. They maintain consistent system mist pressure for all lubrication points
2. They deliver a measured amount of mist flow to each point, as determined by their orifice size.

Every lubrication point requires a reclassifier fitting.

Since oil-mist can be applied to a wide array of machine elements (bearings, gears, chains, etc), Alemite offers four different types of fittings. Each type provides a different degree of reclassification of the dry mist into a suitable degree of wetness to adequately lubricate the element

Mist Fittings

Primarily used for enclosed bearing housings and rely on the bearing velocity to provide the reclassifying function. They are used on both pure mist and purge mist applications. Brass fittings have black zinc finish.

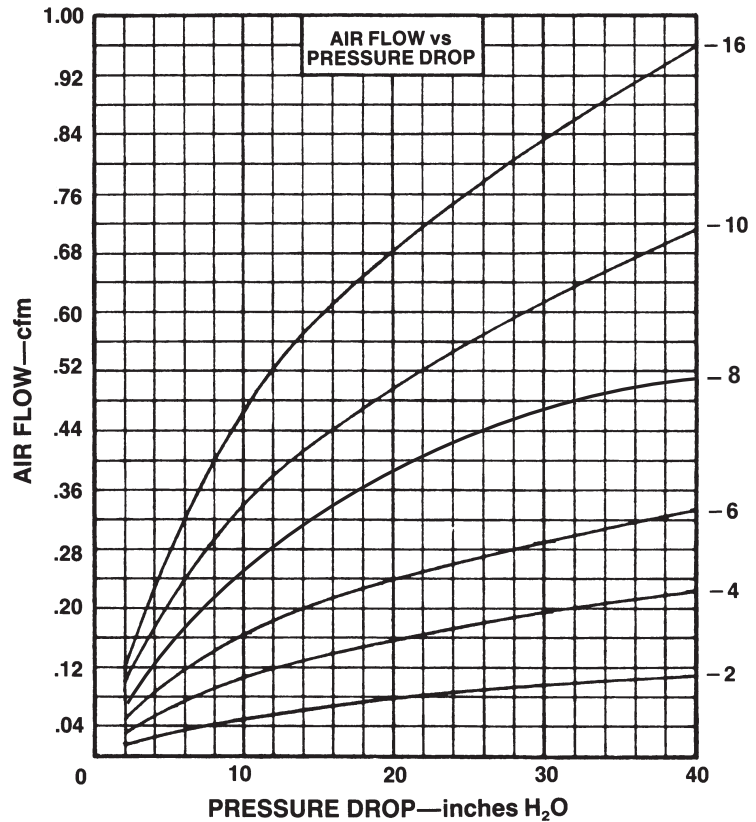

Inlet 1/8" NPT*(f)		Inlet** 1/4" OD tube fitting		Orifice		
Outlet		Outlet 1/8" PTF*(m)				
1/8" PTF*(m)	1/4" NPT(m)	Brass	303 SS	Diameter	Length	Flow area
380791-2	-	381290-2	387603-2	0.032"	0.44"	0.0008
380791-4	381303-4	381290-4	387603-4	0.045"		0.0016
380791-6	381303-6	381290-6	387603-6	0.055"		0.0024
-	-	381290-8	387603-8	0.068"		0.0036
-	381303-10	381290-10	387603-10	0.078"		0.0048
-	381303-16	381290-16	387603-16	0.089"		0.0062



* SAE special short

** Includes nut and sleeve



OIL-MIST LUBRICATION SYSTEMS

OIL-MIST SYSTEM COMPONENTS

Spray Fittings

Compared with mist fittings, spray fittings convert a greater percentage of mist into a wetter spray. Primarily used to lubricate chain, gear teeth and slow-moving equipment. Can also be used to apply a thin oil film on surfaces. Chisel-point tip should be located within 1/2" to 1" of surface to be lubricated. Fittings have black zinc finish.

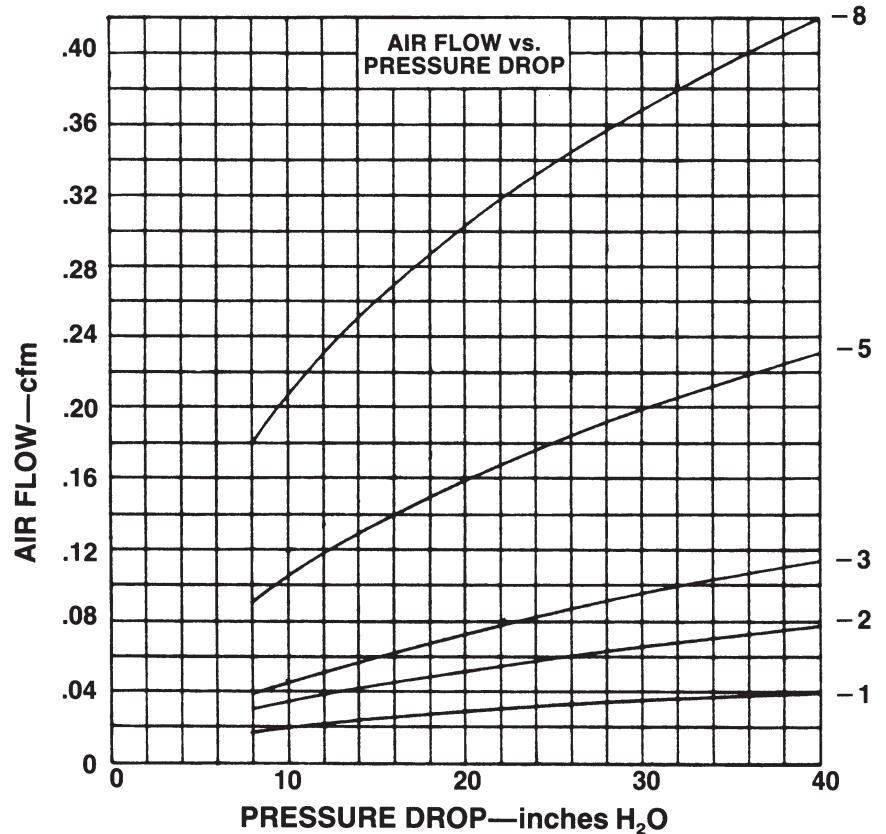

Inlet 1/8" NPT(m)	Inlet 1/4" OD tube fitting	Orifice		
		Diameter	Length	Flow area
381283-1	381288-1	0.024"	1.38"	0.000452
381283-2	381288-2	0.035"		0.000962
381283-3	381288-3	0.042"		0.00138
381283-5	381288-5	0.055"		0.00237
381283-8	381288-8	0.067"		0.00352





OIL-MIST LUBRICATION SYSTEMS

OIL-MIST SYSTEM COMPONENTS

Condensing Fittings

These fittings convert mist into liquid oil within the fitting itself. The condensed oil flows by gravity to the machine element. Fittings are made of brass with a bright zinc finish.

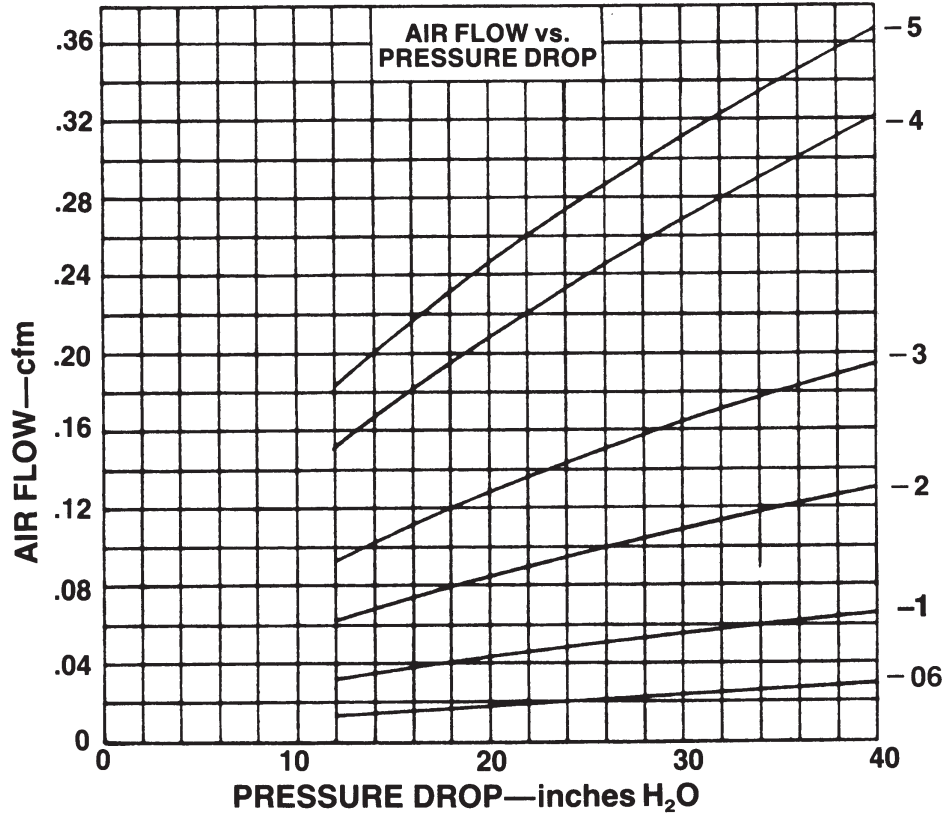

Inlet 1/8" NPTF(m)	Inlet 1/4" OD tube fitting	Orifice (baffled)		
Outlet 1/8" PTF*(m)	Outlet 1/8" PTF*(m)	Size	Length	Flow area
381281-06		SLOT .014 R	0.38	0.0003
381281-1	381282-1	SLOT .020 R		0.0006
381281-2	381282-2	2 SLOTS .020 R		0.0012
381281-3	381282-3	3 SLOTS .020 R		0.0018
381281-4	381282-4	5 SLOTS .020 R		0.0030
381281-5	381282-5	6 SLOTS .020 R		0.0036

* SAE special short

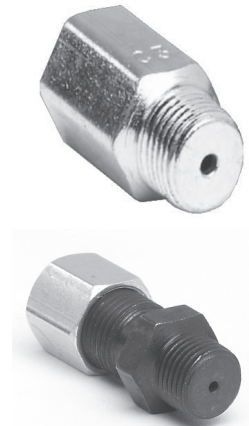



OIL-MIST LUBRICATION SYSTEMS

OIL-MIST SYSTEM COMPONENTS

Spray Nozzle Fittings

Like spray fittings, spray nozzle fittings convert mist into a wetter spray. Whenever the required mist flow exceeds the capacity of the maximum spray fitting size, spray nozzle fittings are used. Spray nozzle fittings contain from 1 to 14 flow holes. Each hole passes the same amount of mist as the largest spray fitting. One-end threaded fittings (not shown) are usually installed from inside a very large bearing housing and have a tightening slot on the opposite end. Fittings are brass.

One end threaded		Both ends threaded		No. of orifices **	Total flow area
1/2" NPTF(m)	3/4" NPTF(m)	1/4" NPTF(m)	1/2" PTF*(m)		
326370-1		383588-1	384280-1	1	0.00352 in ²
326370-2		383588-2	384280-2	2	0.00704 in ²
326370-3		383588-3	384280-3	3	0.01056 in ²
326370-4		383588-4	384280-4	4	0.01408 in ²
326370-5		383588-5	384280-5	5	0.01760 in ²
326370-6		383588-6	384280-6	6	0.02112 in ²
326370-7		383588-7	384280-7	7	0.02464 in ²
326370-8			384280-8	8	0.02816 in ²
326370-9			384280-9	9	0.03168 in ²
326370-10	383617-10		384280-10	10	0.03520 in ²
	383617-11			11	0.03872 in ²
	383617-12			12	0.04224 in ²
	383617-13			13	0.04576 in ²
	383617-14			14	0.04928 in ²

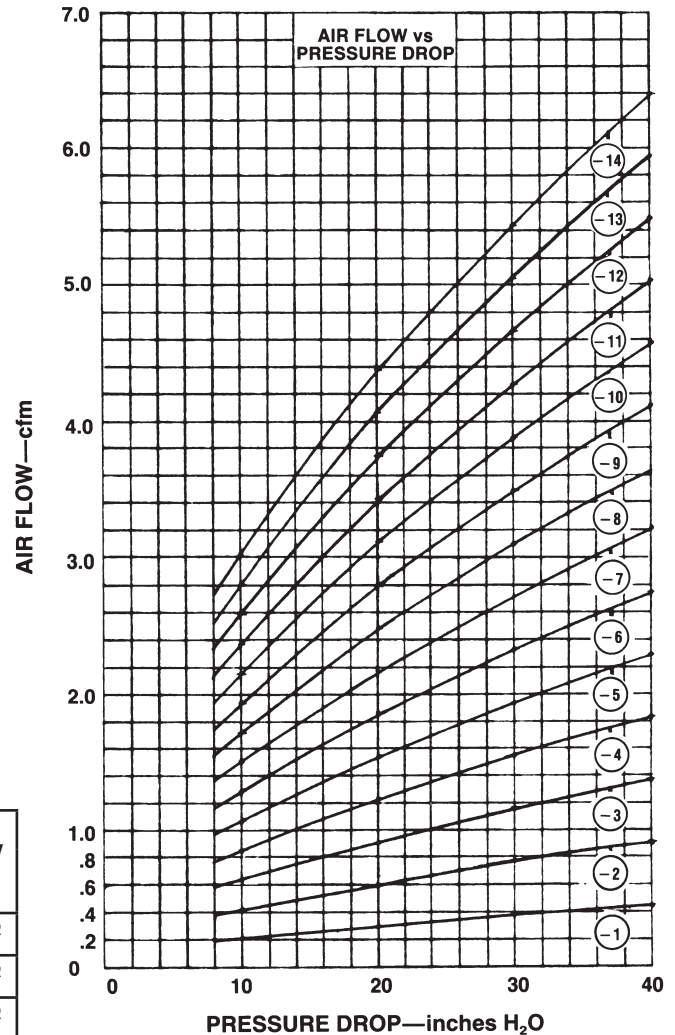

* SAE short

** 0.067 dia - 1.38 lg



OIL-MIST LUBRICATION SYSTEMS

OIL-MIST SYSTEM COMPONENTS

Manifold blocks

Designed to provide multiple threaded outlets from one mist header drop line. Two (2) mounting clamps included with all aluminum manifold blocks.

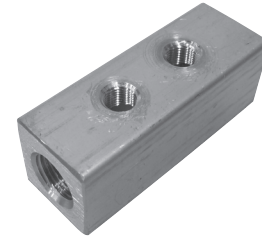
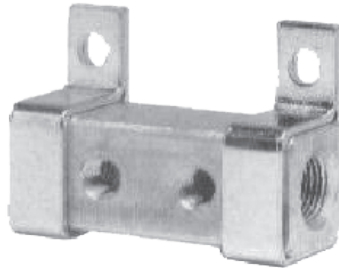

381192-2



381193-2



381190-2



381174-2



388037

Product #	Material	Size	End ports	1/8" NPT(f) outlet ports	Location	Length
381192-2	Aluminum	1 1/8" Square	3/8" NPT(f) Both ends	2	On one side	3"
381193-2				3	On one side	4"
381173-2				4	Two on one side, two on opposite side	3"
381174-2				8	Four on one side, four on opposite side	5"
381190-2				8	Four on one side, four on adjacent side	5"
388037	304 SS	1 1/2" Hex	3/4" NPT(f) & 1/2" NPT(f)	6	Two on each opposite flat	3"

P/N 48925 – End port pipe plug, 3/8" NPT(m)

P/N 1480 – Outlet port pipe plug, 1/8" NPT(m)



OIL-MIST LUBRICATION SYSTEMS

OIL-MIST SYSTEM COMPONENTS

Sight glass with snap valve (P/N 385662-A1)

Clear acrylic sight glass provides visual check of condensed oil. Brass snap valve permits quick draining and closes when released. Used on both manifold blocks and bearing housing drains. Includes 1/2" NPT(m) adapter. Add P/N 339596 adapter to attach to aluminum manifold blocks.

Sight glass with 304SS snap valve (P/N 388243)

Clear acrylic sight glass provides visual check of condensed oil. 304SS snap valve permits quick draining and closes when released. Used on both manifold blocks and bearing housing drains. Includes 304SS 1/2" NPT(m) adapter.



385662-A1

SS mist manifold assembly (P/N 388236)

Includes SS manifold block (P/N 388037), 4" long acrylic sight glass (P/N 388237), SS push-button drain valve, SS adapters and 3/8" OD SS tube fitting.



388236

Mist collection container (P/N 387613)

72-oz Nalgene® bottle with special aluminum cap allows condensed oil and vented mist to be collected from up to six bearing housings. Translucent bottle allows visual inspection of oil level. Bottle is easily removable for proper disposal of condensed oil. Compatible with both mineral and synthetic oils. Cap has six (6) 1/4" NPT(f) connections.

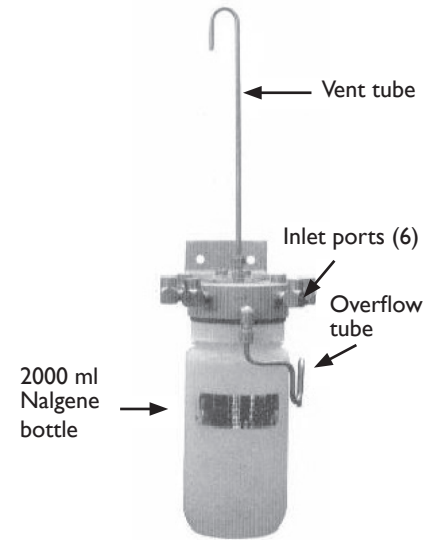

387613



OIL-MIST LUBRICATION SYSTEMS

OIL-MIST SYSTEM COMPONENTS

Manual refill pump and hose/ filter assembly (P/N 388034)

Permits refilling of mist generator oil reservoirs during operation. Includes Reservoir Refill Hose Assembly P/N 380696 (7' hose with 40-micron cleanable filter and loader coupler) that assures only clean, filtered oil enters reservoir. Pump has 3-gallon container and carry handle. Required on 1-pint, 1-gallon and modular mist generators without auto-refill capability.



388034

Purge mist lubrication kit (P/N 388252)

Includes all parts required to provide purge mist to one piece of equipment.

1. M2 SS reclassifier/mist fitting
2. 1/4" SS tubing
3. Purge mist manifold assembly
4. 3/8" SS tubing
5. Oil leveler sight bottle
6. Exhaust/oil drain to collection container, 3/8" SS tubing
7. Mist exhaust tube
8. Collection container
9. 3/4" Drain valve
10. Oil overflow tube
11. 3/8" SS tubing
12. 3/8" NPT or 1/2" NPT pump exhaust
13. Pump cross section (ref)
14. Mist manifold assembly
– SS manifold
– Sight glass
– Pushbutton sight glass drain valve
15. Mist inlet
16. Mist exhaust
17. 1/2" NPT pump connection
18. Oil sump refill port

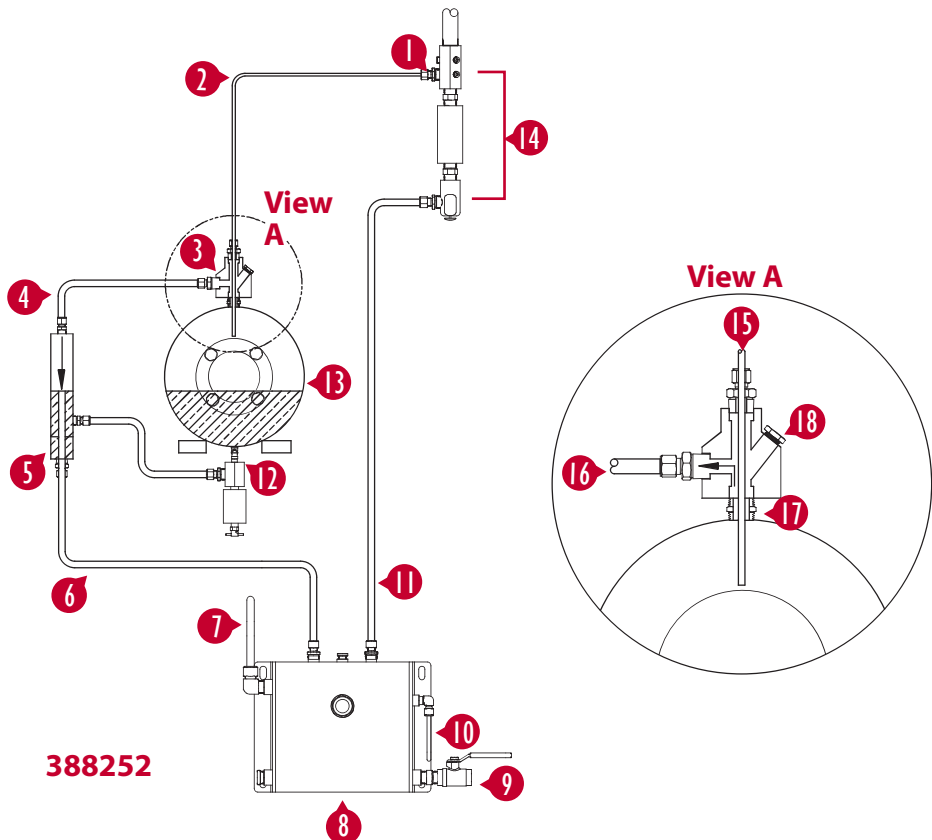

388252



OIL-MIST LUBRICATION SYSTEMS

OIL-MIST SYSTEM ACCESSORIES

Automatic refill pump package (P/N 388415)

Includes 1:1 ratio air-driven pump with accessories including filter/regulator, 7' long hose and valves. For 55-gallon oil drums only.

Can only be used with the following units:

Modular generators –
C and D models only

High-capacity generators –
3720 and 3730 models that have
optional auto-refill kit.

Oil drum not included.

1. Hose assembly P/N 317803-3
2. Hose assembly P/N 317813-7
3. Suction tube P/N 338147-4
4. Filter/regulator P/N 7936
5. 1/2" NPT union P/N 17737
6. Adapter P/N 51888
7. 1/2" NPT full port valve P/N 388217
8. Ram pump P/N 9916-A1

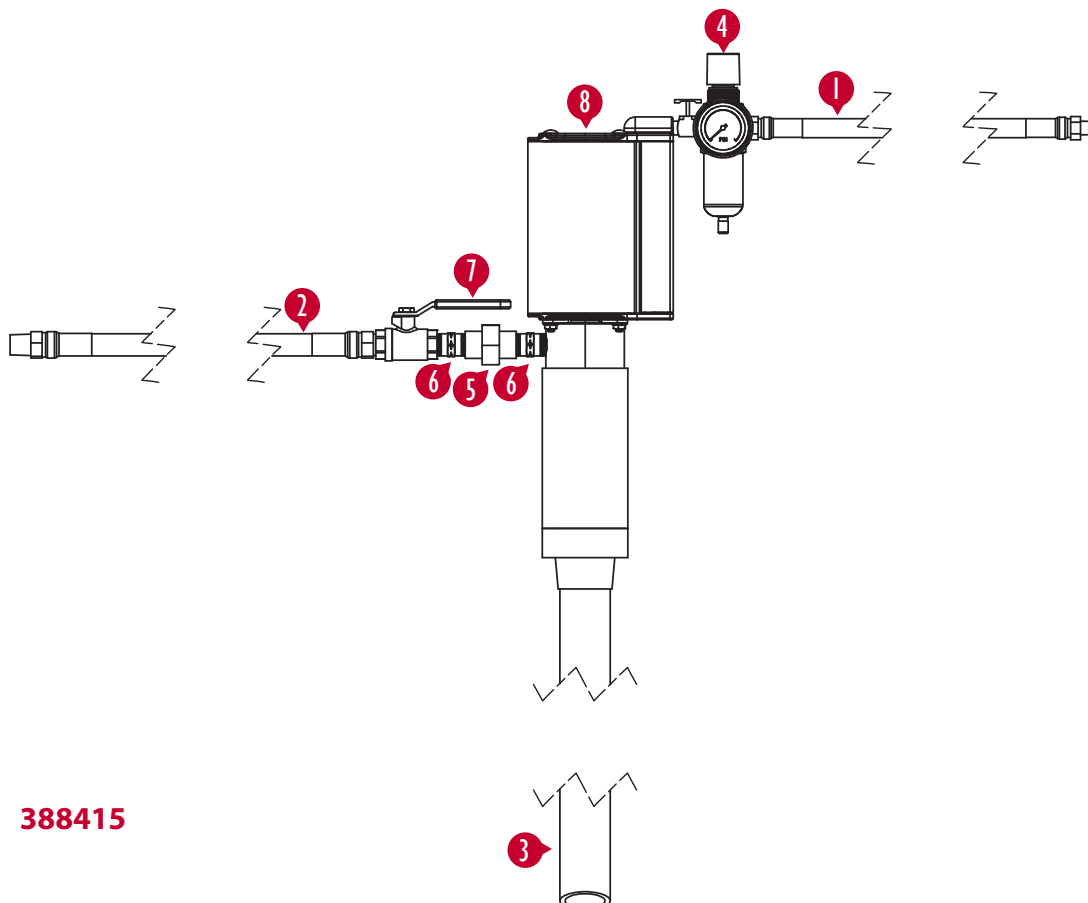

388415



OIL-MIST LUBRICATION SYSTEMS

OIL-MIST SYSTEM ACCESSORIES

Mist pressure gauge (P/Ns 384889, 382064)

When installed in the mist distribution header of 1-pint and 1-gallon mist generators, these gauges provide visual assurance of proper mist pressure in the system. Included in other mist generator models. Gauges measure 0 to 100" H₂O.



384889 –
1/4" NPT(m) back mount

382064 –
1/8" NPT(m) bottom mount

Alarm annunciator (P/N 387275)

Provides both visual and audible warning of system faults when connected to oil level float switch and low/high mist pressure switch (optional). Includes red and green status lights, as well as audible horn with disable switch.

Dry contacts provided to energize remote alarms (10 amp max).
120 V AC, 50/60 Hz

NEMA 4X non-metallic enclosure with mounting bracket.

Dimensions:
6.4" wide x 8.4" tall x 4.8" deep

Use with all models that do not have status lights.



387275

Mist pressure switch (P/N 385033)

When installed in the mist distribution header of 1-pint and 1-gallon mist generators (and used in conjunction with an optional alarm annunciator), this switch responds to either a rise or a drop in system pressure by sending an alarm signal to the alarm annunciator. Factory set at 8" H₂O (falling) and 55" H₂O (rising) mist pressure. Settings can be easily adjusted in the field.

Rated for 10 amp @ 120 V AC.

1/4" NPT(f) pipe connection and
1/2" NPSM(f) conduit connection.



385033



OIL-MIST LUBRICATION SYSTEMS

OIL-MIST SYSTEM ACCESSORIES

Mist monitor (P/N 387596)

Features a fiber-optic sensor designed to continuously monitor the established output of the oil mist generator. Includes electronic control cabinet, fiber-optic cables and mist manifold.

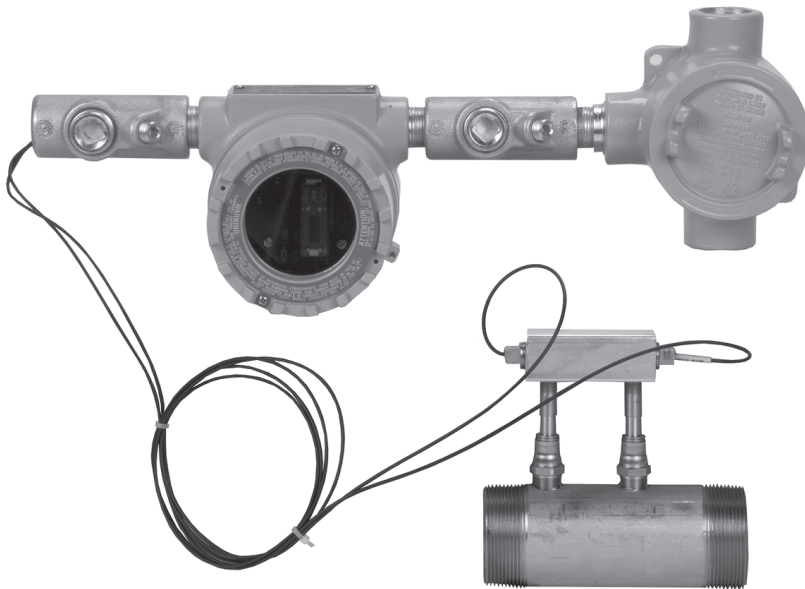

387596



OIL-MIST LUBRICATION SYSTEMS

TECHNICAL DATA

Mist Nozzle Performance Curves

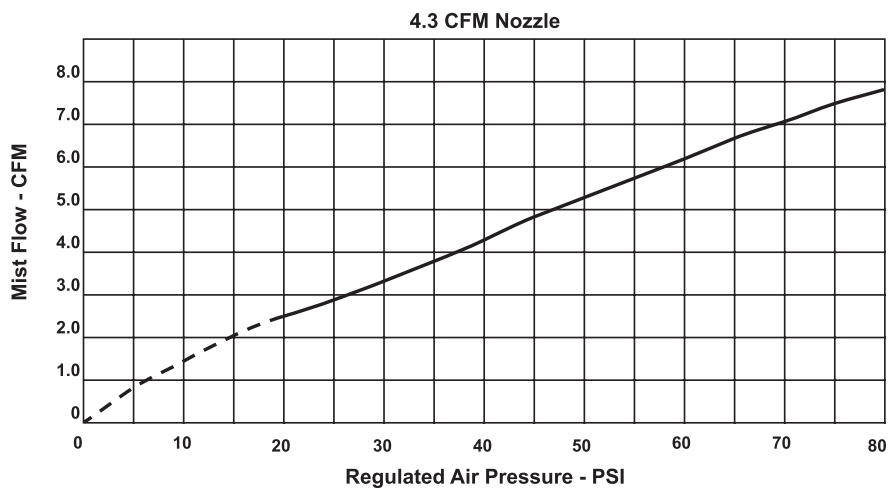
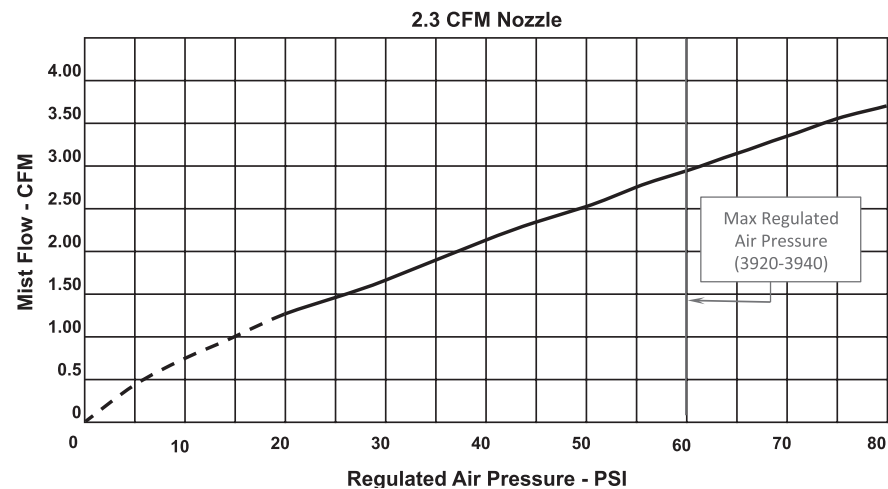
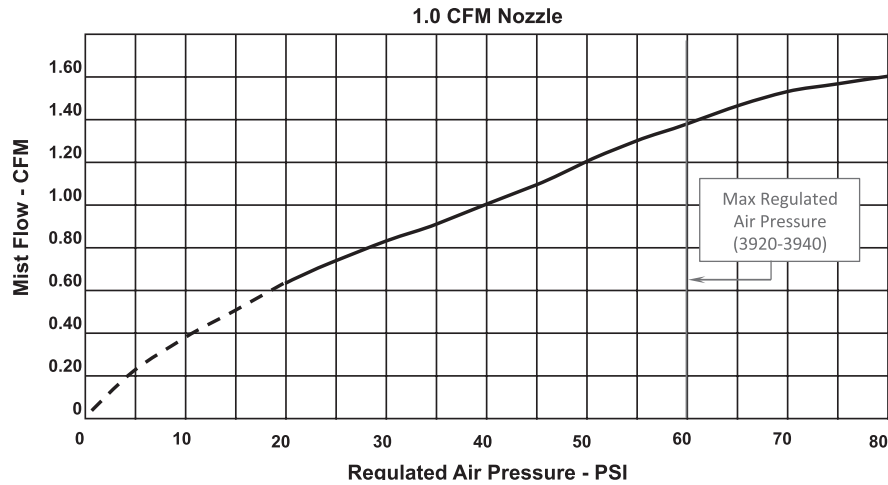



OIL-MIST LUBRICATION SYSTEMS

TECHNICAL DATA

Mist Nozzle Performance Curves

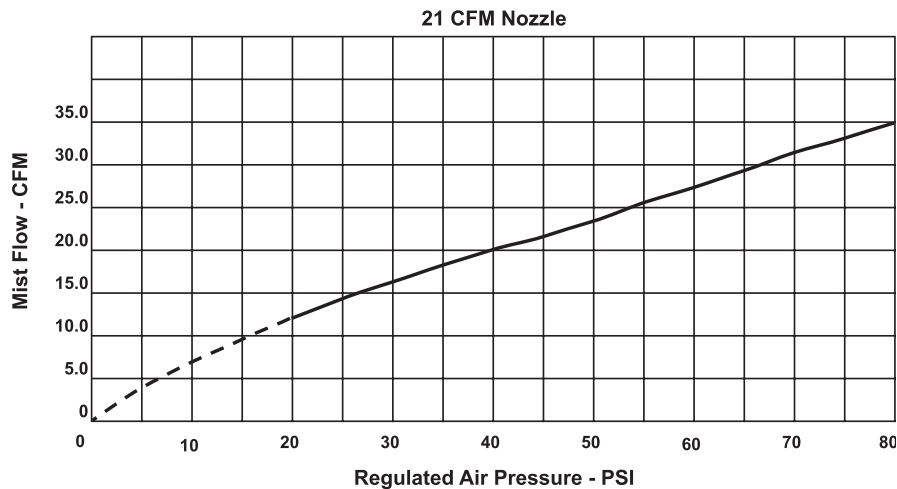
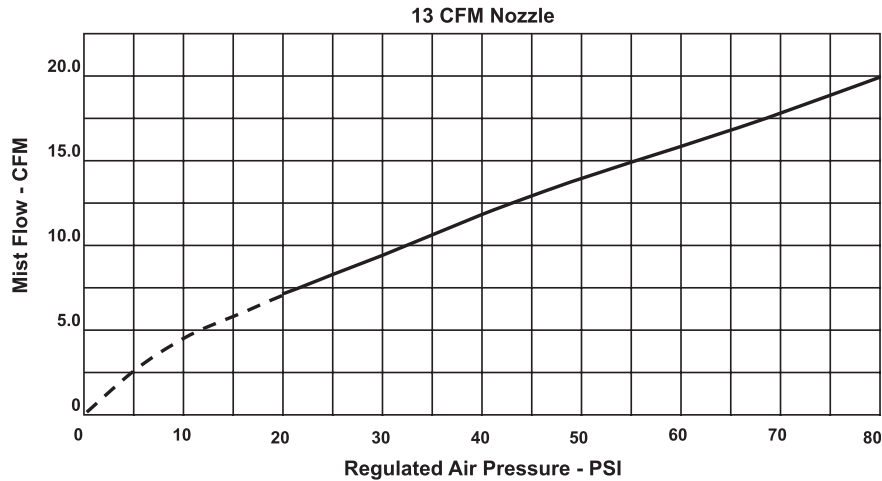
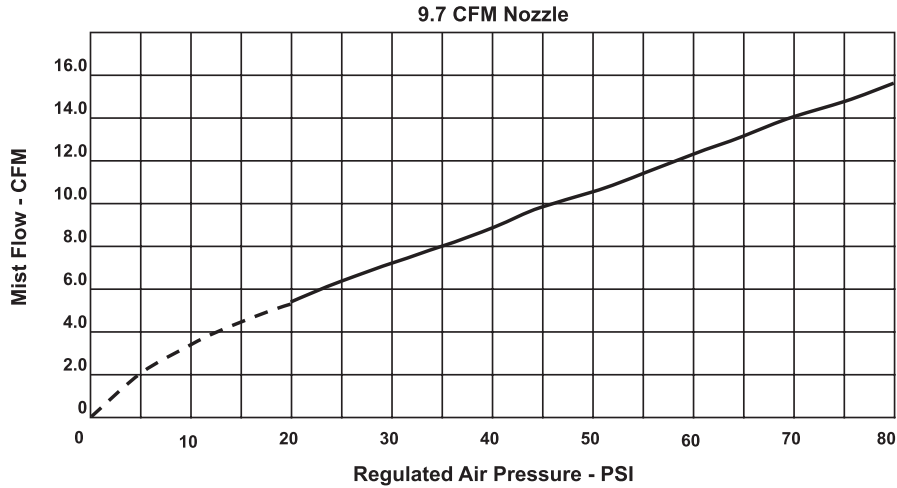



OIL-MIST LUBRICATION SYSTEMS

TECHNICAL DATA

Large Capacity Generators with Thermo-Aire Air Heaters

9.7 CFM Nozzle - 3700 Series

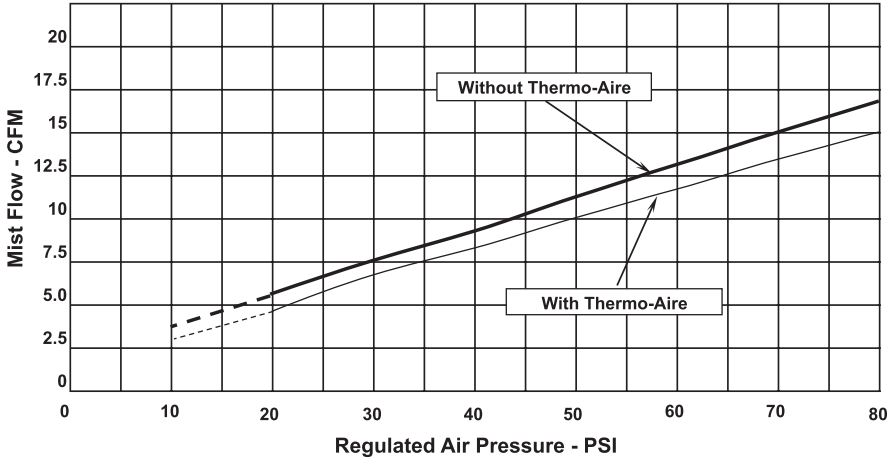

13 CFM Nozzle - 3700 Series

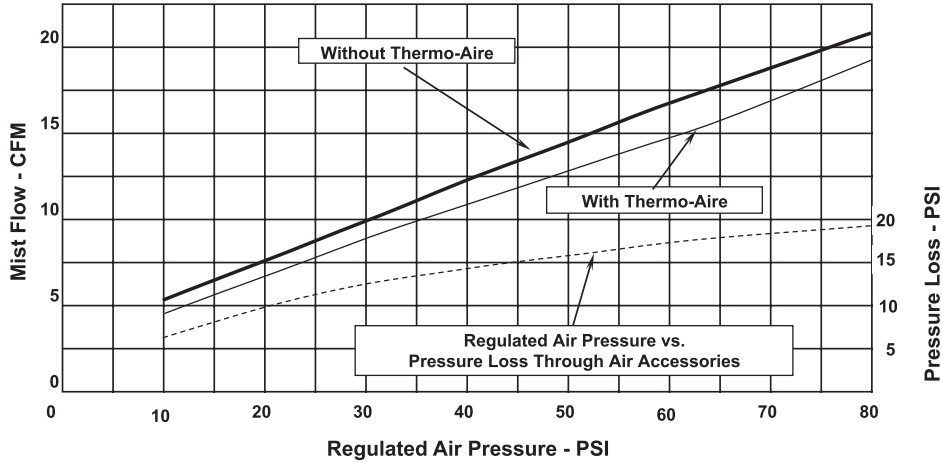

21 CFM Nozzle - 3700 Series

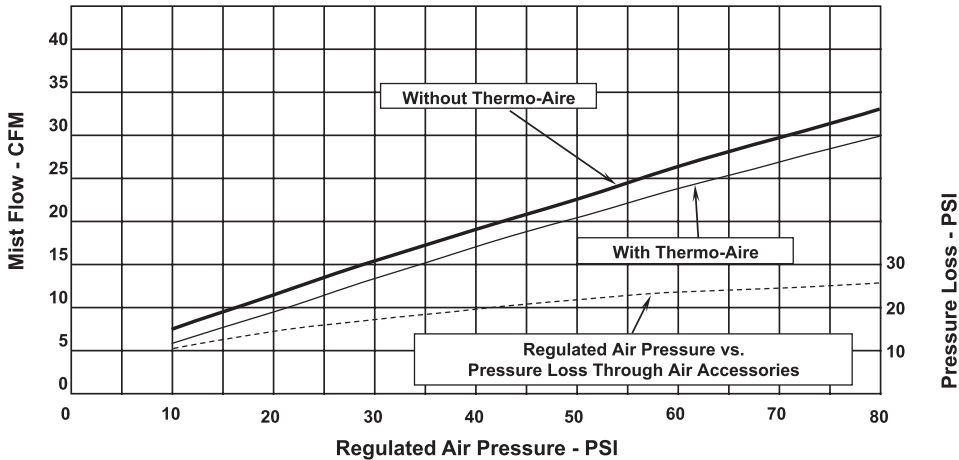



OIL-MIST LUBRICATION SYSTEMS

TECHNICAL DATA

Large Capacity Generators with Thermo-Aire Air Heaters

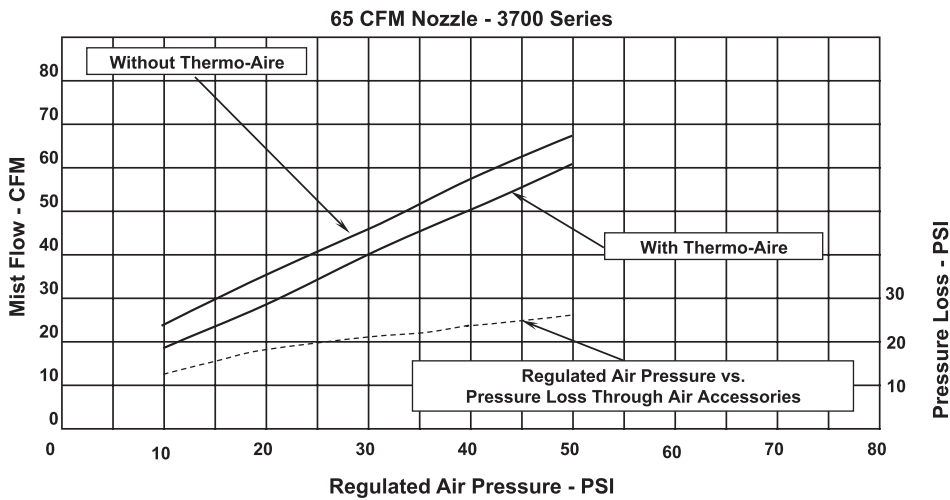
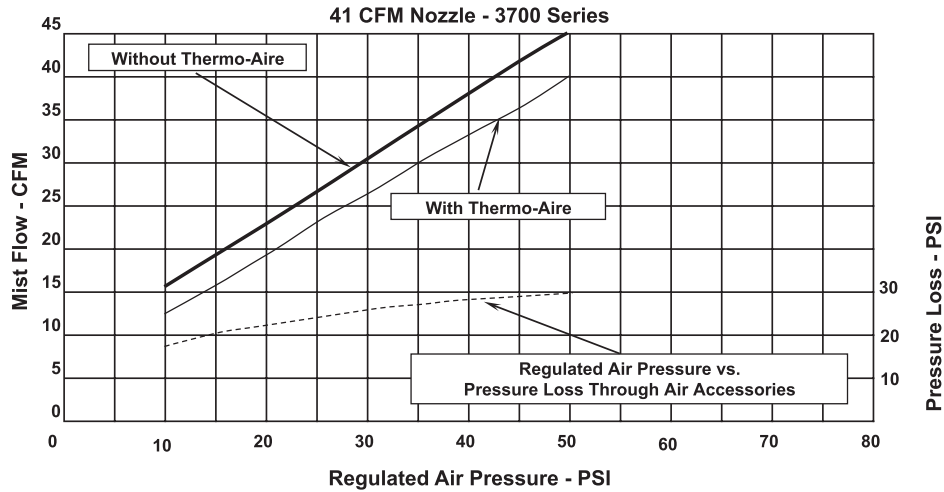



OIL-MIST LUBRICATION SYSTEMS

TECHNICAL DATA – DIMENSIONS

3920 Series

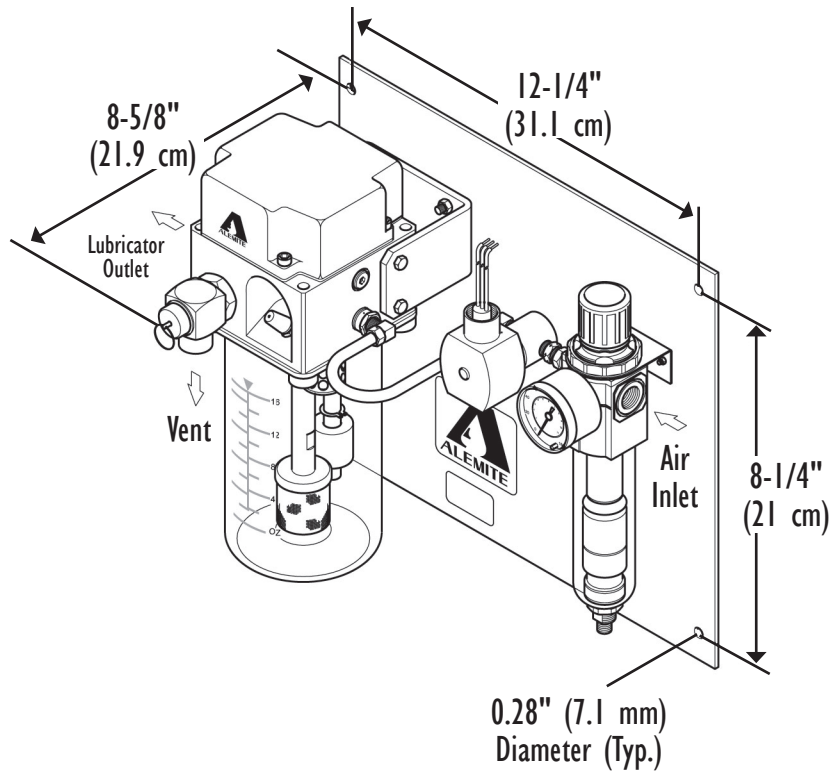

3940 Series

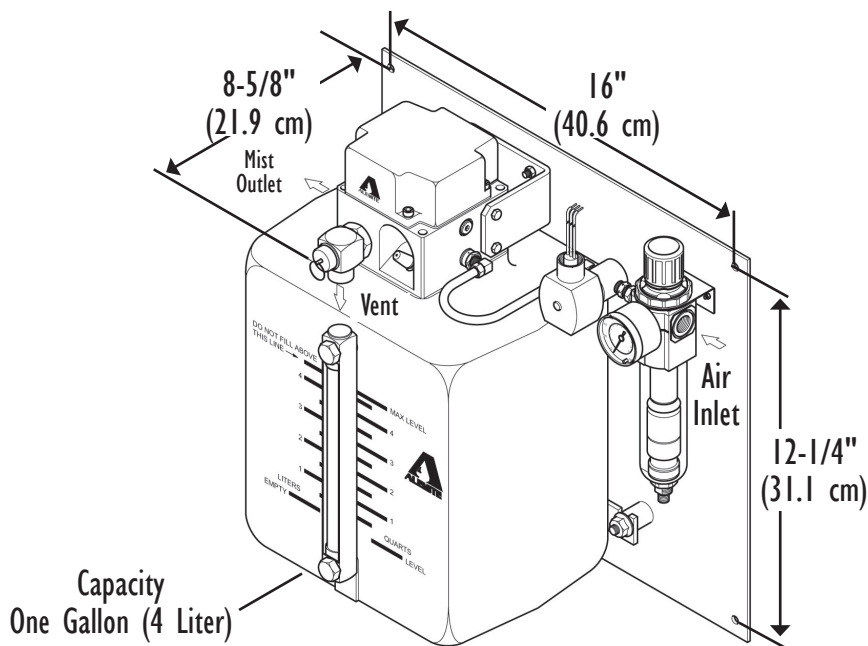



OIL-MIST LUBRICATION SYSTEMS

TECHNICAL DATA – DIMENSIONS

Modular Generators – A version

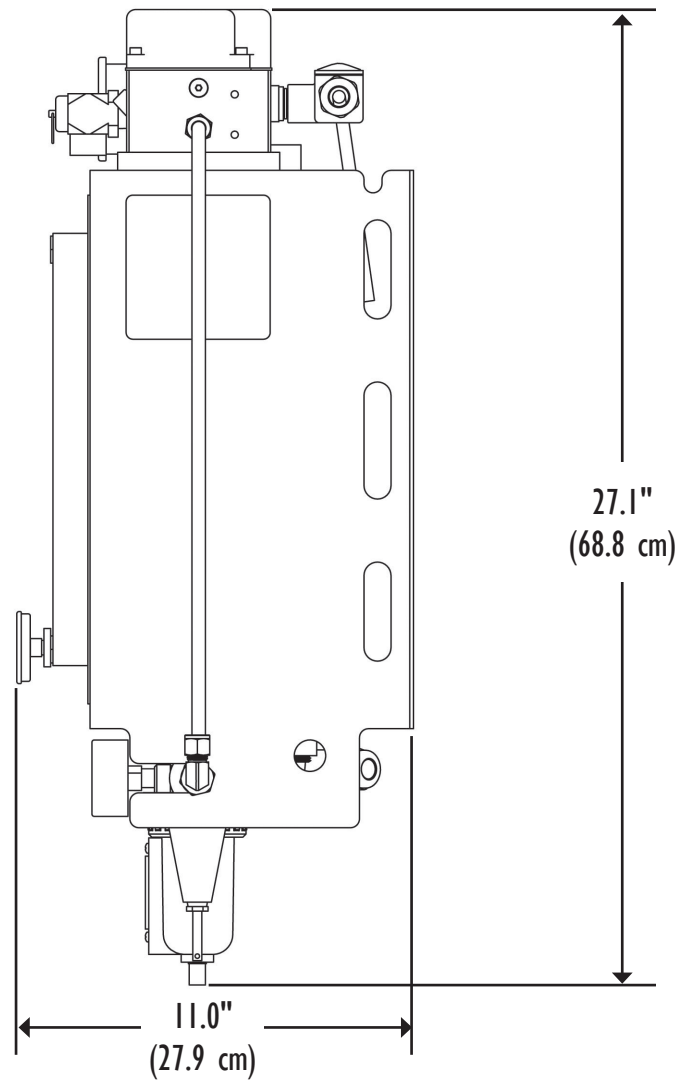
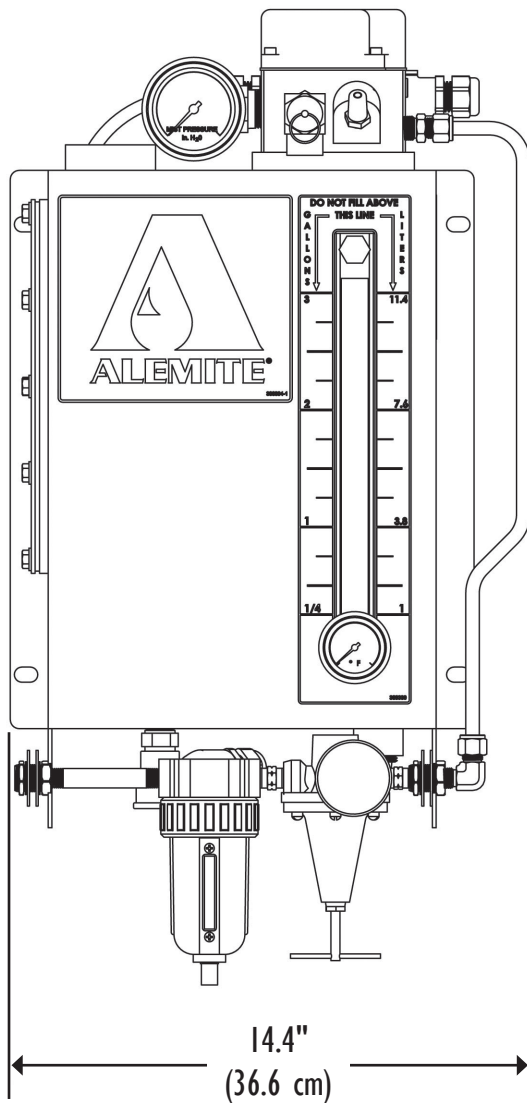



OIL-MIST LUBRICATION SYSTEMS

TECHNICAL DATA - DIMENSIONS

Modular Generators - B - E versions

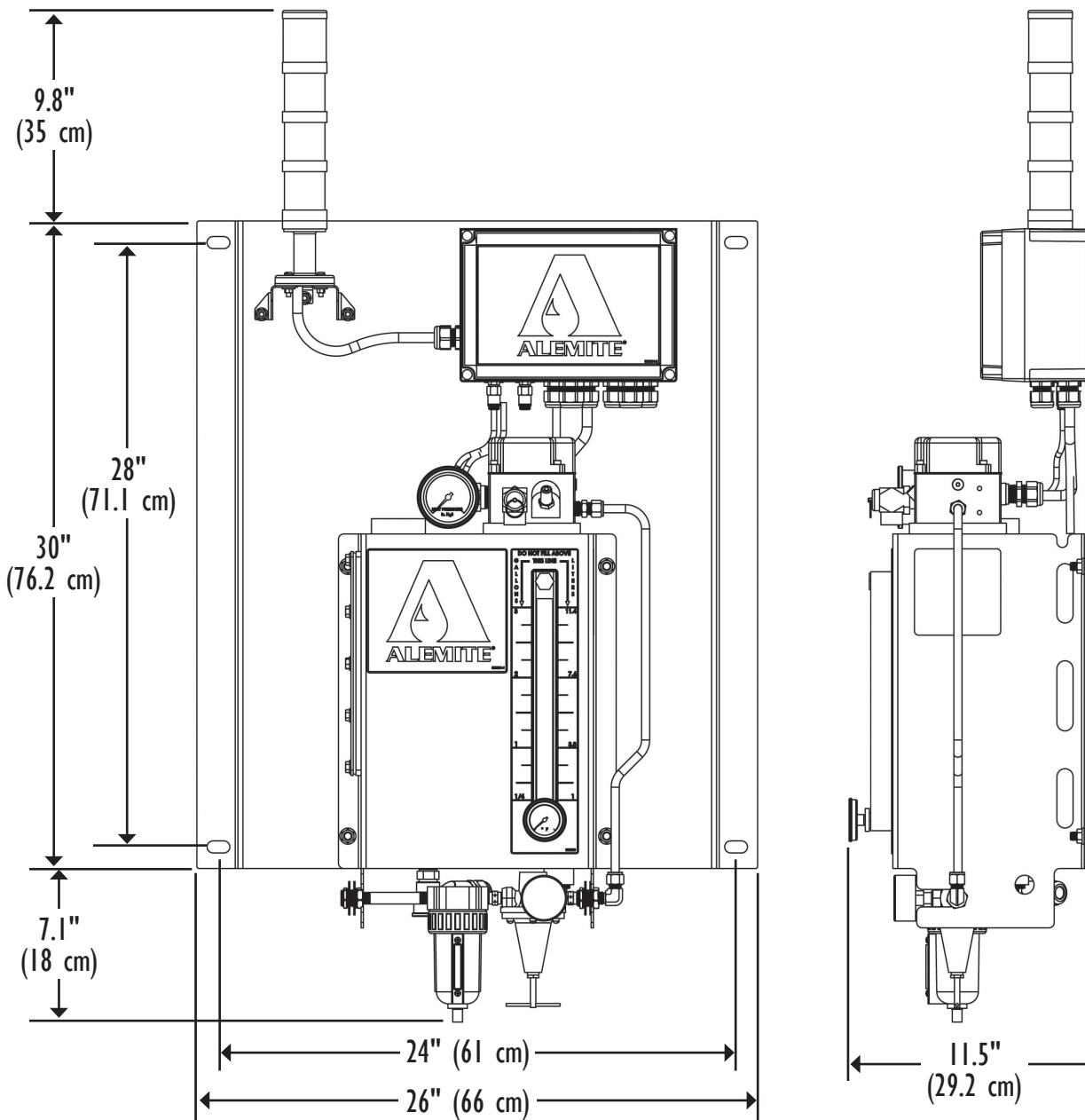



OIL-MIST LUBRICATION SYSTEMS

TYPICAL INSTALLATION SKETCHES

3940 Series

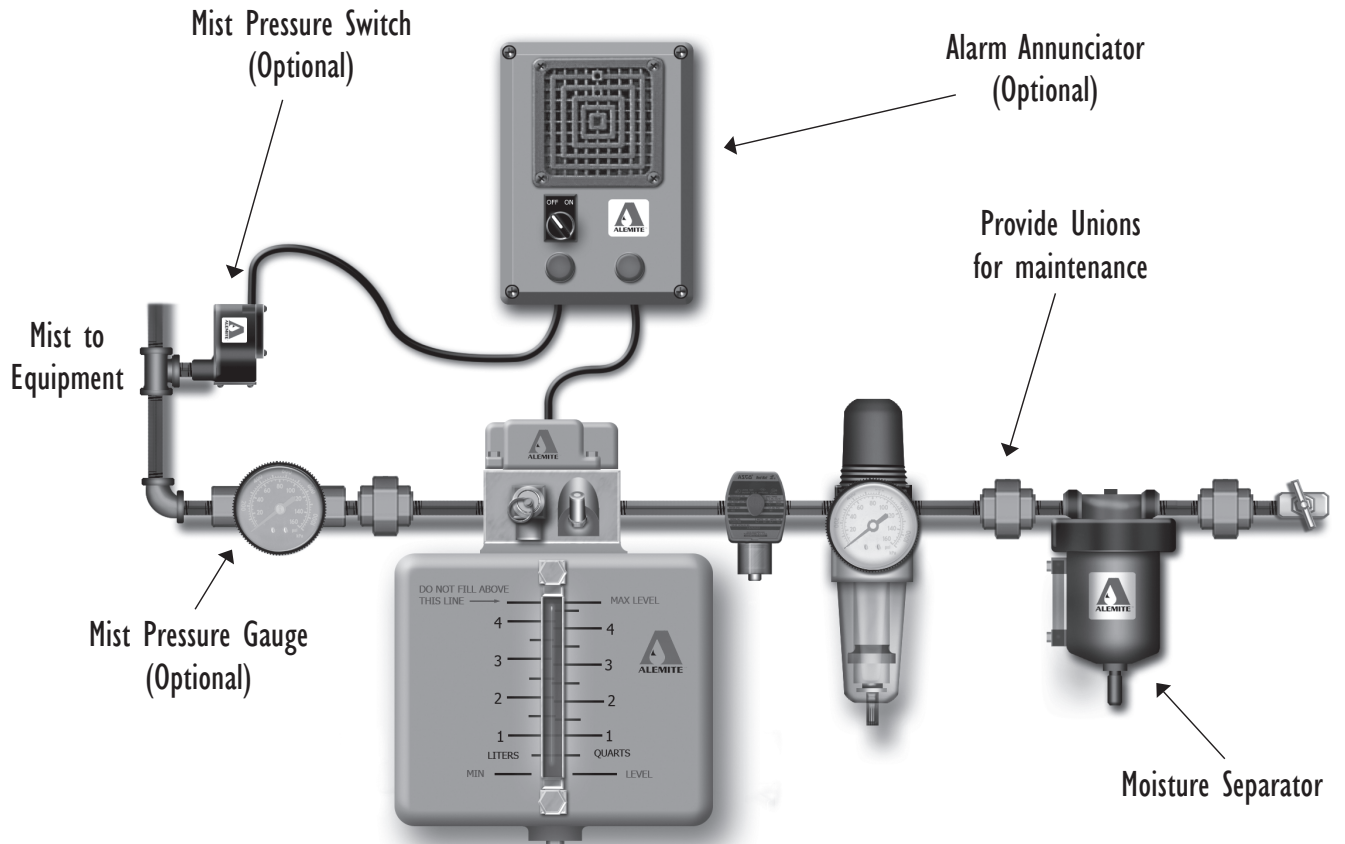



OIL-MIST LUBRICATION SYSTEMS

TYPICAL INSTALLATION SKETCHES

3940 Series

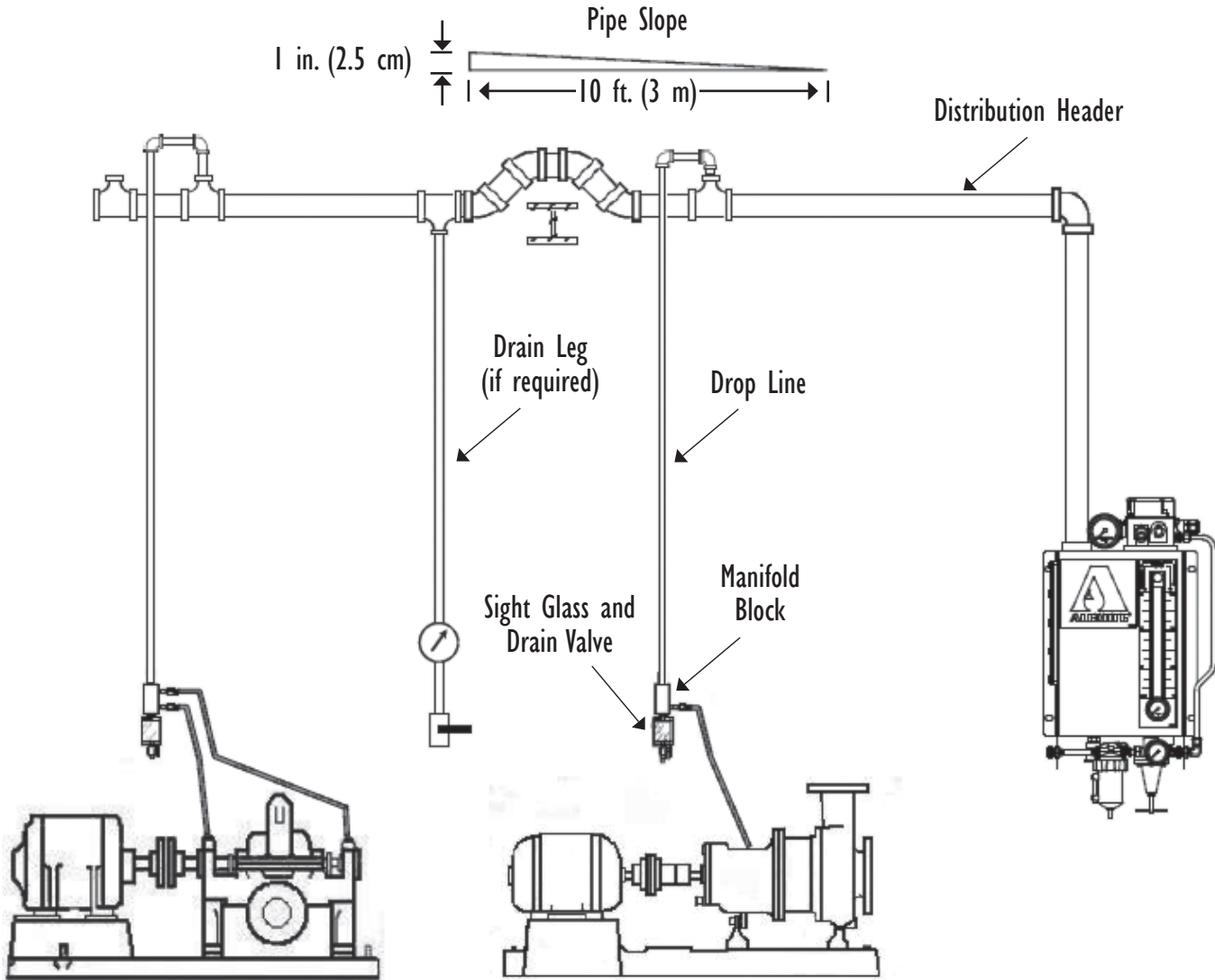



OIL-MIST LUBRICATION SYSTEMS

CARBON SHIELD EM FOR HAZARDOUS LOCATIONS

Alemite offers oil-mist consoles suitable for Class I, Div. 2 hazardous locations. For more information, please contact Alemite.

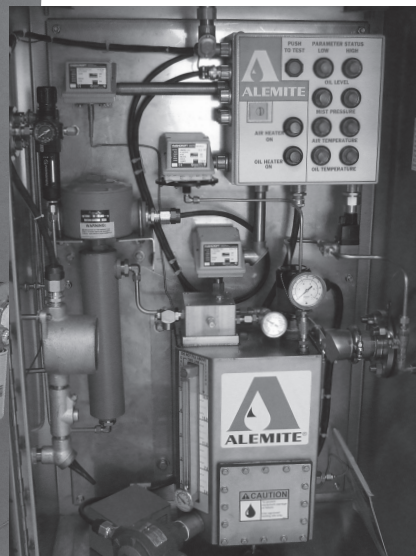
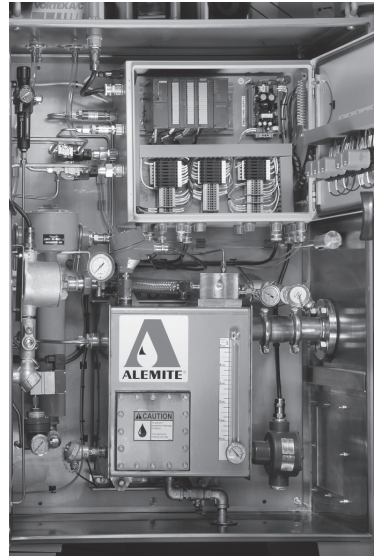

CARBON SHIELD

View a demonstration of carbon shield systems
www.alemitecarbonshield.com



OIL-MIST LUBRICATION SYSTEMS

INDEX

<u>P/N</u>	<u>PAGE</u>	<u>P/N</u>	<u>PAGE</u>	<u>P/N</u>	<u>PAGE</u>
1480	14	326370-3	13	382064	18
3720 Series	27	326370-4	13	383588-1	13
3720-A6	8	326370-5	13	383588-2	13
3720-B6	8	326370-6	13	383588-3	13
3721-A6	8	326370-7	13	383588-4	13
3721-B6	8	326370-8	13	383588-5	13
3722-A6	8	326370-9	13	383588-6	13
3722-B6	8	326370-10	13	383588-7	13
3725-A6	8	338147-4	17	383617-10	13
3726-A6	8	339596	15	383617-11	13
3726-B6	8	380696	16	383617-12	13
3730 Series	27	380791-2	10	383617-13	13
3730-BW6	9	380791-4	10	383617-14	13
3730-RW6	9	380791-6	10	383647	8, 9
3731-BW6	9	381173-2	14	383647-1	8, 9
3731-RW6	9	381174-2	14	384280-1	13
3732-BW6	9	381190-2	14	384280-2	13
3732-RW6	9	381192-2	14	384280-3	13
3736-BW6	9	381193-2	14	384280-4	13
3736-RW6	9	381281-06	12	384280-5	13
3940 Series	5	381281-1	12	384280-6	13
3920 Series	4	381281-2	12	384280-7	13
3922-A	4	381281-3	12	384280-8	13
3922-AC	4	381281-4	12	384280-9	13
3922-B	4	381281-5	12	384280-10	13
3922-BC	4	381282-1	12	384889	18
3922-BD	4	381282-2	12	385033	18
3942-BC	5	381282-3	12	385662-A1	15
3942-BD	5	381282-4	12	387275	8, 9, 18
3942-CB	5	381282-5	12	387596	19
3942-CC	5	381283-1	11	387603-2	10
3942-DD	5	381283-2	11	387603-4	10
3943-B	5	381283-3	11	387603-6	10
3943-BC	5	381283-5	11	387603-8	10
3943-BD	5	381283-8	11	387603-10	10
3943-CB	5	381288-1	11	387603-16	10
3943-CC	5	381288-2	11	387613	15
3943-DD	5	381288-3	11	387789	8, 9
7936	17	381288-5	11	388034	4, 5, 7, 16
9916-A1	17	381288-8	11	388037	14, 15
17737	17	381290-2	10	388217	17
31152-C	7	381290-4	10	388236	15
31159-A	7	381290-6	10	388237	15
32304-B	7	381290-8	10	388243	15
48925	14	381290-10	10	388252	16
51888	17	381290-16	10	388415	7, 8, 9, 17
317803-3	17	381303-4	10		
317813-7	17	381303-6	10		
326370-1	13	381303-10	10		
326370-2	13	381303-16	10		



ALEMITE

NOTES



NOTES